

AR60 Dual Shock Mount Instructions

Step 1:

- Install one dual shock bracket at a time. Place bracket on outside of axle link mount.

Step 2:

- Insert screw through top bracket hole and through the axle link mount. While sliding through, insert the 5/16" spacer and fasten using a locknut.

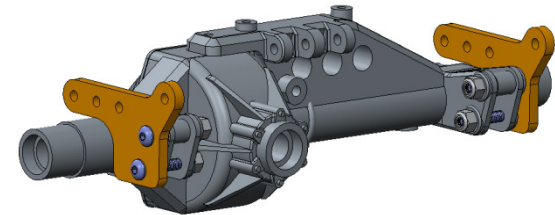

Step 3:

- Insert bottom 4-link bar in lower location.
- Slide screw through the bottom bracket hole, 4-link rod end, and axle link mount.
- Fasten using a locknut.
- Repeat for other side.

